

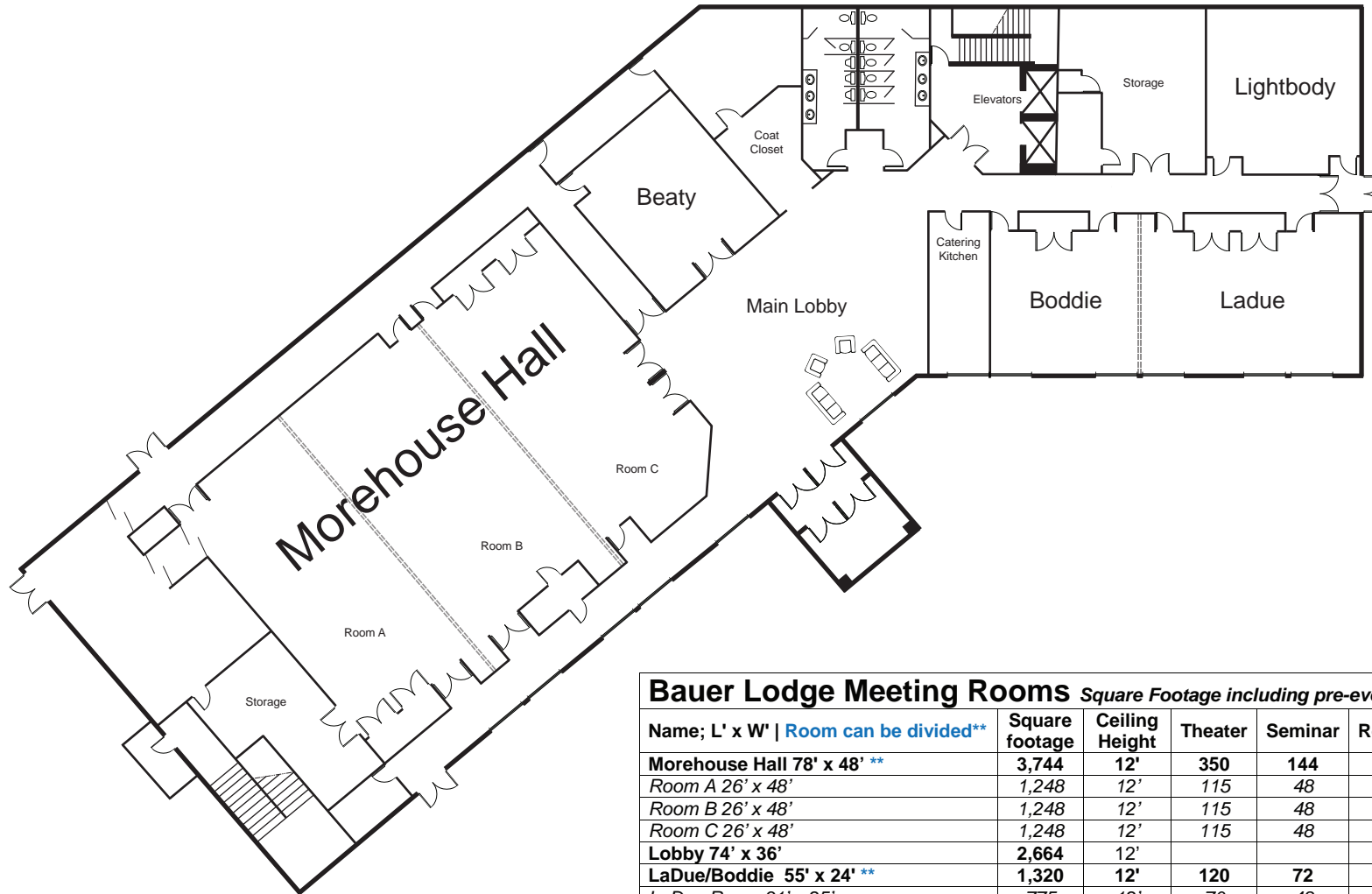

GREEN LAKE
 CONFERENCE CENTER
WWW.GLCC.ORG
 W2511 State Road 23
 Green Lake, WI 54941
 (920) 294-3323

Bauer Lodge



Bauer Lodge Meeting Rooms <i>Square Footage including pre-event space: 8,904</i>									
Name; L' x W' Room can be divided**	Square footage	Ceiling Height	Theater	Seminar	Rounds	Class room	Circle	Hollow Square	
Morehouse Hall 78' x 48' **	3,744	12'	350	144	200	120	80	80	
Room A 26' x 48'	1,248	12'	115	48	65	40	25	25	
Room B 26' x 48'	1,248	12'	115	48	65	40	25	25	
Room C 26' x 48'	1,248	12'	115	48	65	40	25	25	
Lobby 74' x 36'	2,664	12'							
LaDue/Boddie 55' x 24' **	1,320	12'	120	72	80	64	40	40	
LaDue Room 31' x 25'	775	12'	70	48	48	40	30	32	
Boddie Room 25' x 25'	625	12'	50	32	32	24	25	24	
Beaty 25' x 24'	600	12'	50	32	32	24	25	24	
Lightbody 24' x 24'	576	10'	50	32	32	24	25	24	

Meeting Room Setup Chart

Green Lake Conference Center • www.glcc.org • guestservices@glcc.org • 920-294-3323

Name; L' x W' Room can be divided**	Square footage	Ceiling Height	Theater	Seminar	Rounds	Class room	Circle	Hollow Square
Pillsbury Hall 109' x 73'	7,957	14'	900	600	400	160	100	96
Lakeview Meeting Room 109' x 73'	7,957	10.8'	400	270	180	72	45	45
Morehouse Hall 78' x 48' ***	3,744	12'	350	144	200	120	80	80
Lone Tree 77' x 36' ****	2,772	10.1'	140	96	N/A	48	40	40
Brayton Case 54' x 49' **	2,646	11.4'	240	128	144	100	70	64
Cummings Dining Room 46' x 39'	1,794	14'	150	80	96	60	50	48
Huber-Evans 46' x 39'	1,794	13.9'	150	80	96	60	50	48
LaDue/Boddie 55' x 24' **	1,320	12'	120	72	80	64	40	40
Mitchell Dining Room 62' x 21'	1,302	11.5'	96 in rounds of 8 is the standard setting for this room					
Tower Dining Room 62' x 21'	1,302	11.5'	84 in rounds of 8 is the standard setting for this room					
Red Door B 49' x 26'	1,274	8.8'	100	50	N/A	30	30	30
Boehr/Cary 50' x 25' **	1,250	10'	100	64	64	40	40	40
Hanson/Stansbury 50' x 25' **	1,250	10'	100	64	64	40	40	40
Crystal Meeting Room 54' x 22'	1,188	11'	100	48	64	40	30	40
Missions Meeting Room 41' x 28'	1,148	10.8'	80	48	N/A	40	30	40
Red Door A 39' x 20'	780	8.8'	70	48	N/A	32	35	24
C. Oscar Johnson 35' x 20'	700	8'	70	48	N/A	32	35	24
Brown 25' x 25'	625	10'	50	32	32	24	25	24
Johnson 25' x 25'	625	10'	50	32	32	24	25	24
Beaty 25' x 24'	600	12'	50	32	32	24	25	24
Tea House 30' x 20'	600	9.6'	70	48	N/A	24	30	16
Lightbody 24' x 24'	576	10'	50	32	32	24	25	24
Martin Luther King, Jr. 25' x 21'	525	7'	40	24	N/A	16	25	16
Mahaney 30' x 15'	450	9.4'	40	24	N/A	16	25	16
McGarvey 30' x 15'	450	9.4'	40	24	N/A	16	25	16
Roblee 23' x 15'	345	10.8'	25	16	16	12	20	14
Ballenger 19' x 18' **	342	8'	20	12	16	12	15	14
Cox 19' x 18' **	342	8'	20	12	16	12	15	14
Dominguez 19' x 18' **	342	8'	20	12	16	12	15	14
Fordham 19' x 18' **	342	8'	20	12	16	12	15	14
Jones 19' x 18' **	342	8'	20	12	16	12	15	14
Ng 19' x 18' **	342	8'	20	12	16	12	15	14
Kraft Conference Room 23' x 12.5'	288	7.8'	Conference table seats 12.					
Vesper Circle - Outdoor Amphitheater	15,000+	100'+	400 seating capacity on benches.					
Kraft Banquet Hall 150' x 80'	12,000	34'	These are other-purposed rooms which can be configured for meeting space.					
Bauer Lobby 74' x 36'	2,664	12'						
South Hall Lounge 35' x 32'	1,120	10'						
North Hall Lounge 34' x 31'	1,054	10'						
Pillsbury Hall Lobby 43' x 23'	989	11.6'						
Lakeview Lobby 43' x 23'	989	11'						
Kern Lobby 37' x 26'	962	9.4'						
Ollie's Internet Café 30' x 22'	660	9.8'						

Meeting Room Setups

Seminar

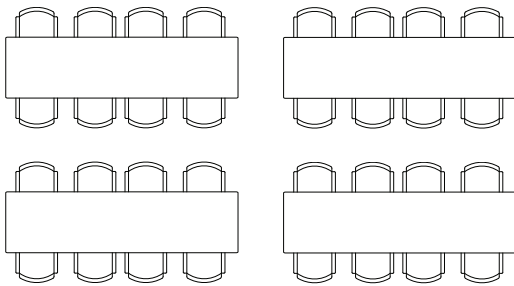

Rounds

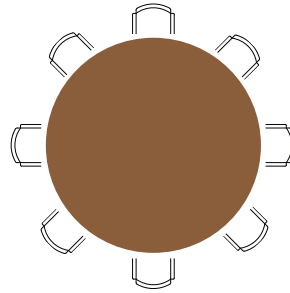

Theater

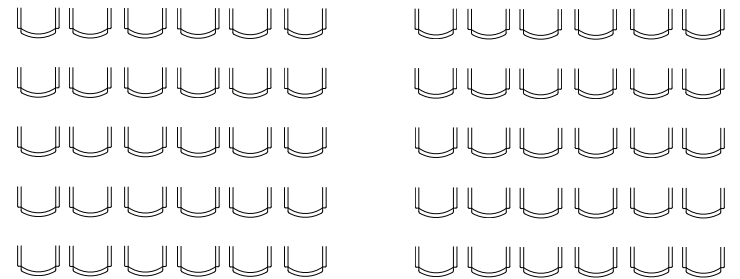

Hollow Square

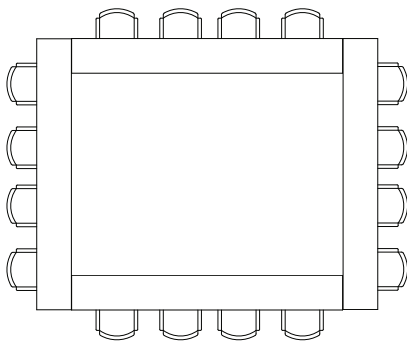

Crescent With Round Table

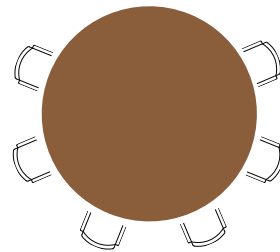

Circle

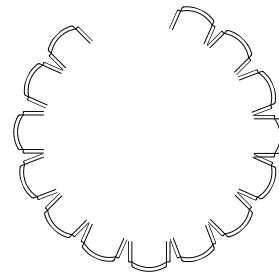

Classroom

